

TOWN OF SIDNEY

HIGHWAY 17

WEST CYCLE PATH REPLACEMENT

FROM MCDONALD PARK ROAD TO MALAVIEW AVENUE

WEST

ISSUED FOR TENDER

PROJECT No. 2099-6

DRAWING INDEX	
DWG NO	DWG NAME
GENERAL	
2099-6-000	COVER SHEET, DRAWING INDEX, KEY PLAN, AND LOCATION PLAN
2099-6-001	GENERAL NOTES
CIVIL	
2099-6-101	BIKE PATH UPGRADES PLAN AND PROFILE SHEET 1 OF 6
2099-6-102	BIKE PATH UPGRADES PLAN AND PROFILE SHEET 2 OF 6
2099-6-103	BIKE PATH UPGRADES PLAN AND PROFILE SHEET 3 OF 6
2099-6-104	BIKE PATH UPGRADES PLAN AND PROFILE SHEET 4 OF 6
2099-6-105	BIKE PATH UPGRADES PLAN AND PROFILE SHEET 5 OF 6
2099-6-106	BIKE PATH UPGRADES PLAN AND PROFILE SHEET 6 OF 6
2099-6-107	ADDITIONAL PATH LIGHTING
2099-6-108	BIKE PATH UPGRADES SECTIONS SHEET 1 OF 2
2099-6-109	BIKE PATH UPGRADES SECTIONS SHEET 2 OF 2
2099-6-110	STANARD DETAILS

SHEETS 104 - 107 AND 109 HAVE BEEN CONSTRUCTED AND HAVE BEEN LEFT OUT FOR CLARITY

PREPARED FOR:



DESIGNED BY:

ONSITE
Engineering Ltd.

ABBOTSFORD OFFICE
#103-32310 SOUTH FRASER WAY
ABBOTSFORD, BC, V2T 1X1
PH.: 604-309-1788
FAX: 866-235-6943

EGBC PERMIT TO PRACTICE No.: 1002678

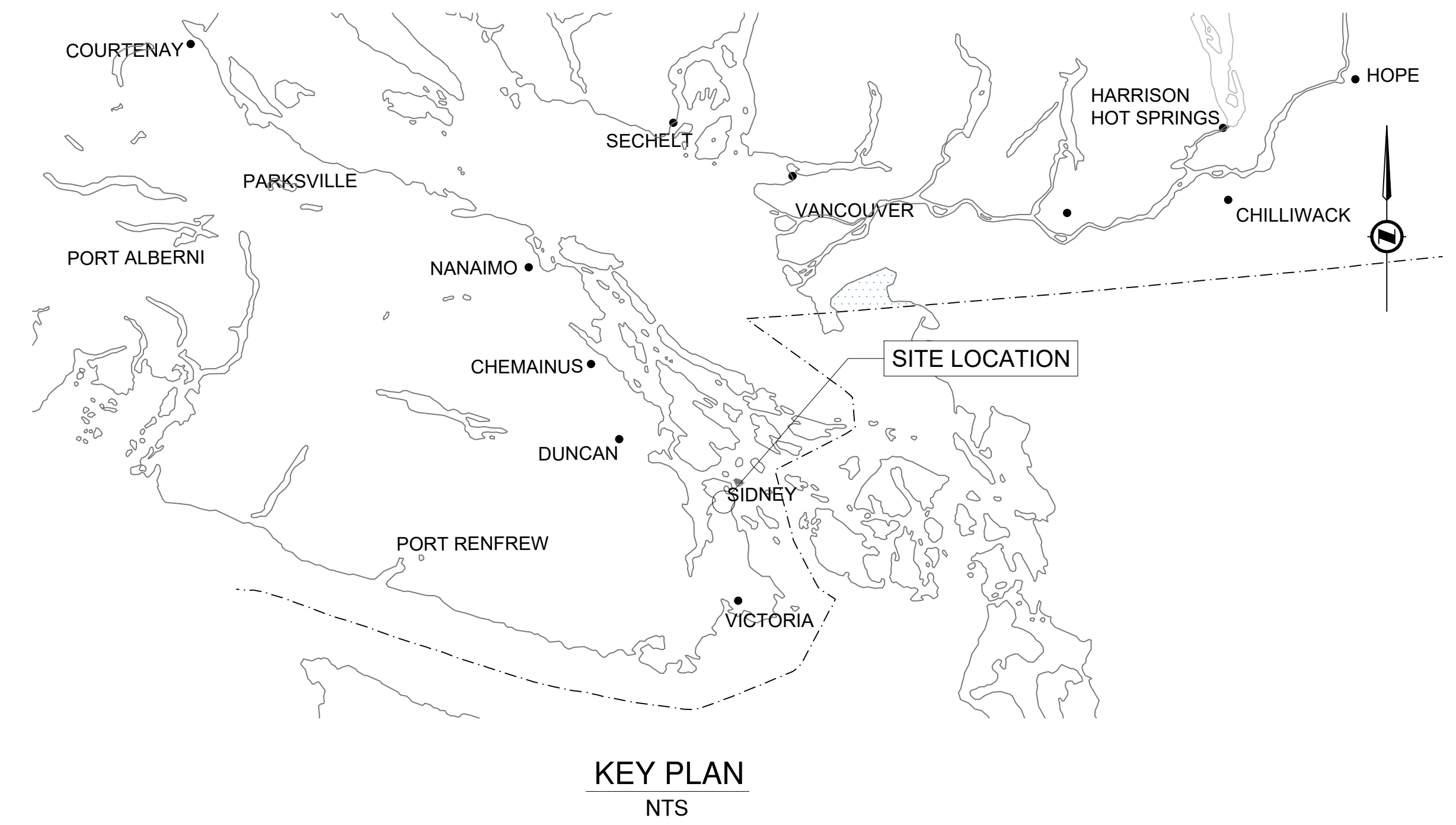

GENERAL NOTES:

- THE TOWN SHALL ARRANGE A PRE-CONSTRUCTION MEETING PRIOR TO THE START OF CONSTRUCTION.
- ALL CONSTRUCTION AND MATERIALS SHALL BE IN ACCORDANCE WITH:
 - THE TOWN OF SIDNEY SUBDIVISION BY-LAW NO. 1990, LATEST REVISION;
 - FOR CONSTRUCTION CONTRACT DRAWINGS AS PER THE FORM OF AGREEMENT - SIGNED & SEALED BY PROFESSIONAL ENGINEER
 - APPLICABLE CONTRACT DOCUMENTS AND ALL SPECIFICATIONS REFERENCED THEREIN.
 - MINISTRY OF ENVIRONMENT AND/OR FEDERAL DEPARTMENT OF FISHERIES AND OCEANS REQUIREMENTS;
 - MINISTRY OF TRANSPORTATION "B.C. TRAFFIC CONTROL MANUAL FOR WORK ON ROADWAYS", LATEST EDITION;
 - WORKSAFEBC, LATEST EDITION.
- THE CONTRACTOR SHALL MAINTAIN ON SITE COPIES OF THE ABOVE DOCUMENTS AND SHALL ENSURE THAT ALL TRADES ARE THOROUGHLY FAMILIAR WITH THE APPLICABLE SECTIONS OF THE DOCUMENTS.
- ALL ELEVATIONS ARE GEODETIC AND ARE REFERENCED TO EXISTING INTEGRATED SURVEY MONUMENTS.
- THE CONTRACTOR SHALL REGISTER A BC ONE CALL BEFORE START OF CONSTRUCTION 1-800-474-6886.
- THE CONTRACTOR SHALL EXPOSE AND VERIFY THE LOCATION AND ELEVATION OF ALL EXISTING SERVICES IN THE FIELD PRIOR TO CONSTRUCTION AND NOTIFY THE CONSULTANT'S CONTRACT ADMINISTRATOR OF ANY DISCREPANCIES, CONFLICTS OR OMISSIONS PRIOR TO CONSTRUCTION.
- NEW SERVICE CONNECTIONS SHALL BE LOCATED AS PER THE DESIGN DRAWINGS.
- FIGURED DIMENSION SHALL GOVERN OVER SCALED DIMENSIONS.
- LOT DIMENSIONS SHOWN ARE FOR REFERENCE ONLY. REFER TO BCLS REGISTERED LEGAL PLAN FOR ACTUAL LOT DIMENSIONS. THE CONTRACTOR SHALL CONFIRM LOCATIONS OF LOT LINES PRIOR TO INSTALLATION OF SERVICE CONNECTIONS.
- TOWN OF SIDNEY GEODETIC CONTROL MONUMENTS REQUIRING RELOCATING SHALL BE DELIVERED TO THE TOWN FOR REVIEW.
- THE CONTRACTOR SHALL ENSURE THAT ALL APPROVALS REQUIRED FOR THE PROPOSED WORKS HAVE BEEN OBTAINED FROM ALL AUTHORITIES AND AGENCIES PRIOR TO COMMENCING THE WORK.
- THE CONTRACTOR SHALL ARRANGE FOR AND COORDINATE THE WORKS DONE BY
 - TOWN OF SIDNEY,
 - FRANCHISE UTILITIES
- THE CONTRACTOR SHALL CONTACT THE APPROPRIATE PERSONNEL AT LEAST 72 HOURS PRIOR TO THE WORK. SCHEDULING AND OTHER CONSTRUCTION CONSTRAINTS IMPOSED BY THESE WORKS SHALL BE TAKEN INTO ACCOUNT.
- RESIDENTS DIRECTLY AFFECTED BY CONSTRUCTION OF THESE WORKS AND SERVICES SHALL BE GIVEN 48 HOURS WRITTEN NOTICE OF THE PROPOSED START OF CONSTRUCTION. THE TOWN OF SIDNEY SHALL OBTAIN AUTHORIZATION FROM AFFECTED PRIVATE PROPERTY OWNERS PRIOR TO ENTRY BY CONTRACTOR ONTO PRIVATE PROPERTY. FOLLOWING CONSTRUCTION ACTIVITY ON THE AFFECTED PROPERTY A WRITTEN RELEASE MAY BE REQUIRED FROM THE PROPERTY OWNER AT THE DISCRETION OF THE TOWN.
- THE CONTRACTOR SHALL REPAIR OR REPLACE ANY EXISTING STREETS, SERVICES, LANDSCAPING, PRIVATE LANDSCAPING OR PRIVATE IMPROVEMENTS THAT MAY BE DAMAGED AS A RESULT OF CONSTRUCTION. REPAIRS TO EXISTING TOWN SERVICES SUCH AS WATER, SANITARY SEWER, STORM SEWER AND STREET OR TRAFFIC LIGHTING SHALL BE MADE BY THE TOWN AT COST TO THE CONTRACTOR. REPAIRS TO EXISTING SURFACE WORKS MAY BE DONE BY THE TOWN AT THE DISCRETION OF THE TOWN PROJECT MANAGER.
- THE CONTRACTOR SHALL ENSURE THAT TOWN STREETS ARE KEPT CLEAN AND FREE OF EQUIPMENT AND MATERIALS AT ALL TIMES DURING THE CONSTRUCTION PERIOD.
- THE CONTRACTOR SHALL AS PART OF THE WORK PERFORM, OR CAUSE TO BE PERFORMED, ALL TESTS, INSPECTIONS AND APPROVALS OF THE WORK AS REQUIRED BY THE CONTRACT DOCUMENTS. PRIOR TO ISSUANCE OF THE SUBSTANTIAL COMPLETION CERTIFICATE, THE CONTRACTOR SHALL SUBMIT TO THE CONSULTANT'S CONTRACT ADMINISTRATOR COPIES OF ALL TEST RESULTS, COPIES OF REPORTS AND TEST RESULTS SHALL BE SUBMITTED TO THE TOWN. COST OF ALL TESTING SHALL BE INCIDENTAL TO THE CONTRACT.
- A TRAFFIC AND PEDESTRIAN SAFETY CONTROL PLAN SHALL BE SUBMITTED BY THE CONTRACTOR PRIOR TO THE PRE-CONSTRUCTION MEETING.
- THE CONTRACTOR SHALL BE SOLELY RESPONSIBLE FOR CONSTRUCTION SAFETY AT THE PLACE OF WORK AND TO THE EXTENT REQUIRED BY APPLICABLE CONSTRUCTION SAFETY LEGISLATION REGULATION AND CODES, INCLUDING THE WORKERS COMPENSATION ACT AND APPLICABLE REGULATIONS, AND BY GOOD CONSTRUCTION PRACTICE. THE CONTRACTOR SHALL BE THE PRIME-CONTRACTOR UNLESS OTHERWISE CHANGED BY THE CONSULTANT'S CONTRACT ADMINISTRATOR.
- MAINTAIN VEHICULAR AND PEDESTRIAN ACCESS AT ALL TIMES.
- OPEN EXCAVATION EXCEEDING 35 METERS WILL NOT BE PERMITTED AT ANY TIME WITHOUT THE PRIOR APPROVAL. ALL EXCAVATIONS SHALL BE BACKFILLED COMPLETELY PRIOR TO THE END OF EACH SHIFT.
- ENSURE ALL CONSTRUCTION EQUIPMENT USED IN CONJUNCTION WITH THE PROJECT IS IN GOOD REPAIR, HAS UNDERGONE A RECENT MECHANICAL INSPECTION AND IS INSPECTED DAILY TO ENSURE THEY ARE FREE OF LEAKS WHICH COULD RELEASE FUEL, OILS, HYDRAULIC FLUIDS, ANTIFREEZE OR OTHER SUBSTANCES DELETERIOUS TO AQUATIC LIFE AND TO THE MARINE ENVIRONMENT. ANY LEAKS SHALL BE REPORTED IMMEDIATELY AND REPAIRED PRIOR TO CONTINUING WORK.
- CONTRACTOR TO MAINTAIN AN UP-TO-DATE SET OF REDLINE DRAWINGS FOR THE PREPARATION OF AS-CONSTRUCTED DRAWINGS. THE REDLINES ARE TO BE DELIVERED TO THE CONSULTING ENGINEER PRIOR TO SUBSTANTIAL PERFORMANCE. ALL DATA MUST BE ACCEPTABLE TO THE CONSULTING ENGINEER TO PREPARE THE AS-CONSTRUCTED DRAWINGS. MISSING OR INADEQUATE DATA TO BE PROVIDED BY THE CONTRACTOR OR BY A SURVEYOR AT THE CONTRACTOR'S EXPENSE.
- FINAL CLEAN UP TO SATISFACTION OF MINISTRY OF TRANSPORTATION AND INFRASTRUCTURE.
- NO STEEL TRACKED MACHINES ON ASPHALT WITHOUT PROTECTIVE MATTING.
- ANY DAMAGE TO EXISTING TOWN OF SIDNEY INFRASTRUCTURE SHALL BE REPAIRED BY TOS FORCES AT THE CONTRACTOR'S EXPENSE.
- THE CONTRACTOR SHALL NOT RECEIVE COMPENSATION FOR ANY LOSSES THE CONTRACTOR MAY INCUR AS A RESULT OF WORK BEING DELAYED OR SUSPENDED FOR REASONS THAT ARE BEYOND THE CONTROL OF THE TOWN OF SIDNEY. THIS INCLUDES RESTRICTION OF ACCESS TO THE WORK SITE FOR REASONS OF FIRE HAZARDS OR WEATHER CONDITIONS
- CONTRACTOR TO ENSURE EXISTING MONUMENTS AND IRON PINS ARE NOT DISTURBED DURING CONSTRUCTION. ANY MONUMENTS OR IRON PINS IN DANGER OF DISTURBANCE ARE TO BE REFERENCED AND, IF DISTURBED, BE REPLACED BY A BCLS AT THE CONTRACTORS EXPENSE.

DRAWINGS:

- THIS SET OF DRAWINGS SHOWS THE COMPLETED PROJECT. THE DRAWINGS DO NOT SHOW COMPONENTS THAT MAY BE NECESSARY FOR CONSTRUCTION SAFETY. THE CONTRACTOR IS RESPONSIBLE FOR SAFETY IN AND ABOUT THE JOB SITE DURING CONSTRUCTION, AND THE DESIGN AND ERECTION OF ALL TEMPORARY STRUCTURES, FORMWORK, FALSE WORK, SHORING, ETC. REQUIRED TO COMPLETE THE WORK.
- THE INFORMATION ON THESE DRAWINGS SHALL NOT BE USED FOR ANY OTHER PROJECT OR WORKS. THE INFORMATION ON THESE DRAWINGS APPLIES SOLELY TO THIS PROJECT.

STORM AND DRAINAGE:

- ALL CATCH BASINS TO BE AS PER MMCD STD. DWG. S11.
- ENSURE ALL EXISTING DRAIN SYSTEMS REMAIN IN USE DURING CONSTRUCTION AND RECONNECT EXISTING SERVICES TO PROPOSED MAINS AS REQUIRED.
- MINIMIZE ANY EXCAVATION OF THE EXISTING DITCHES. EXCAVATED DITCH SLOPES MUST MATCH EXISTING DITCH GRADE. THE PREFERRED DITCH SLOPE IS 4H:1V IF UNABLE TO MATCH EXISTING DITCH SLOPE.

EXCAVATING AND BACKFILLING:

- WORKS IN SETBACK AREAS, AND DISCHARGE TO CREEKS, STREAMS, AND WATERCOURSES MAY BE SUBJECT TO FEDERAL AND PROVINCIAL AUTHORITY APPROVAL. THE CONTRACTOR SHALL RETAIN THE SERVICES OF A QUALIFIED ENVIRONMENTAL PROFESSIONAL TO COMPLETE ANY REQUIRED STUDIES AND OBTAIN ANY NECESSARY PERMITS AND APPROVALS PRIOR TO CONSTRUCTION.
- TREES LOCATED WITHIN 1.0M OF THE EDGE OF THE TRAIL AS NOTED ON THE GENERAL TRAIL LAYOUT DRAWINGS SHALL BE PRUNED TO THE BOLES OF THE TREE, 3.5M ABOVE THE FINISHED TRAIL GROUND ELEVATION, UNLESS OTHERWISE NOTED. TREES AND SHRUBS LOCATED FURTHER THAN 1.0M AWAY FROM THE EDGE OF THE TRAIL WHOSE BRANCHES IMPACT THE TRAIL MUST BE PRUNED AT LEAST 1.0M BACK FROM THE EDGE OF THE TRAIL AND 3.5M ABOVE THE FINISHED TRAIL GROUND ELEVATION, UNLESS OTHERWISE NOTED.
- NO BORROW OR LOCAL BACKFILL MATERIALS SHALL BE USED.
- THE CONTRACTOR SHALL DISPOSE OF ALL GRUBBED VEGETATION, PRUNED BRANCHES, EXCAVATED OVERBURDEN, AND ANY OTHER SUCH MATERIALS AT AN APPROVED LOCATION OFF SITE.

EARTHWORKS AND GRADING

- EARTHWORKS, INCLUDING STRIPPING ALL LOOSE OR OTHERWISE DELETERIOUS MATERIALS OR SOFT SPOTS, COMPACTING, AND SLOPE GRADING, SHALL BE COMPLETED AS PER CONTRACT DOCUMENTS.
- EMBANKMENTS SHALL BE PLACED, SHAPED, COMPACTED, AND PROTECTED TO STANDARDS AND SPECIFICATIONS AS REQUIRED IN THE CONTRACT DOCUMENTS.
- WHERE INFILLING OF EXISTING DITCHES ETC. IS REQUIRED, AND WHERE SERVICES ARE CONSTRUCTED IN FILL SECTION, FILL MATERIAL SHALL BE GRANULAR MATERIAL, SUPPLIED, PLACED & COMPACTED AS PER MMCD SPECIFICATION.
- ALL SUB-BASE AND GRANULAR BASE MATERIALS SHALL CONFORM TO MMCD SPECIFICATION.
- GEOTECHNICAL CONSULTANT TO REVIEW AND APPROVE NATIVE SUBGRADE PRIOR TO FILL PLACEMENT.
- GEOTECHNICAL CONSULTANT TO REVIEW AND APPROVE FILL MATERIAL PRIOR TO USE.
- REMOVE VEGETATION, STRIP ORGANIC MATERIAL, AND UNSUITABLE MATERIAL, AS REQUIRED, PRIOR TO PLACING STRUCTURAL FILL.
- COMPACT ALL EARTH FILLS AND GRANULAR MATERIAL LAYERS AS PER THE RELEVANT MMCD SPECIFICATIONS.
- ALL PROPOSED GRADING SHALL MEET EXISTING GROUND ELEVATIONS AT ADJOINING PROPERTY LINES UNLESS OTHERWISE NOTED.
- PROTECT ADJACENT PAVEMENT, APPURTENANCES (MANHOLE CASTINGS, VALVE COVERS), AND CURBS FROM DAMAGE.
- CONTRACTOR TO ENSURE THAT ALL THE EXISTING SERVICES REMAIN IN OPERATION DURING CONSTRUCTION.
- MATERIAL SUBSTITUTIONS ARE ACCEPTED ONLY BY WRITTEN PRE-APPROVAL OF THE CONSULTING ENGINEER. FOR ANY AMBIGUITIES IN SPECIFICATIONS THE MOST CONSERVATIVE / ROBUST SPECIFICATIONS SHALL GOVERN.
- WHERE EXCAVATION IS UNDER OR WITHIN 1.0M OF THE EDGE OF A ROAD OR DRIVEWAY, USE PIT RUN GRAVEL BACKFILL FROM THE BASE OF EXCAVATION (WHERE NO CULVERT IS INSTALLED), OR TOP OF PIPE TO THE TOP OF THE ADJACENT SUB-GRADE.
- BED ALL PIPE USING TYPE 1 BEDDING PER MMCD SECTION 31 05 17.
- COMPACT TRENCH BACKFILL, SIDEWALK BASE TO 95% MODIFIED PROCTOR DENSITY.
- UPON COMPLETION OF CONSTRUCTION, ALL AREAS AFFECTED BY THE WORK ARE TO BE REINSTATED TO ORIGINAL OR BETTER CONDITION TO THE SATISFACTION OF THE TOWN OF SIDNEY AND / OR PRIVATE PROPERTY OWNERS IN A PROMPT MANNER TO MINIMIZE LOCAL DISRUPTION.
- ALL UTILITY TRENCHING TO BE IN ACCORDANCE WITH MMCD STD. DWG. G4 AND MMCD SECTION 31 23 01 - EXCAVATING, TRENCHING AND BACKFILLING.
- ALL EXCAVATIONS TO BE AS PER WORK SAFE REQUIREMENTS UNLESS OTHERWISE APPROVED IN WRITING BY A GEOTECHNICAL ENGINEER.
- CONTRACTOR TO RETAIN AND PAY FOR THE SERVICES OF A QUALIFIED INDEPENDENT GEOTECHNICAL TESTING ENGINEER TO PROVIDE QUALITY CONTROL SERVICES DURING CONSTRUCTION AND SHALL PROVIDE THE FOLLOWING AT A MINIMUM UNLESS APPROVED IN WRITING BY A GEOTECHNICAL ENGINEER:
 - SIEVE ANALYSIS OF ALL AGGREGATES
 - STANDARD MODIFIED PROCTOR DENSITY CURVES FOR IMPORTED BACKFILL MATERIALS.
 - TRENCH BACKFILL DENSITY TEST (CULVERTS) - ONE CULVERT INSTALLATION AT EACH 1.0M FILL DEPTH (INCLUDING ONE AT SURFACE LEVEL).

PATH AND PAVING:

- CHANGES OF GRADE AND DIRECTION SHALL BE FORMED BY SMOOTH VERTICAL AND HORIZONTAL CURVES.
- THE CONDITIONS FOR PLACING ASPHALT PAVEMENT AND CONCRETE SHALL CONFORM WITH THE SPECIFICATIONS DETAILED UNDER THE MMCD SUPPLEMENTARY SPECIFICATIONS AND DETAIL DRAWINGS.
- TIE-INS TO EXISTING PAVEMENT SHALL BE MADE BY CUTTING BACK THE EXISTING PAVEMENT TO SOUND MATERIAL AS NECESSARY TO PRODUCE A NEAT VERTICAL FACE. PRIOR TO PLACING ASPHALTIC CONCRETE, EXPOSED PAVEMENT FACES AND OTHER ABUTTING STRUCTURES SHALL BE TACK COATED WITH ASPHALT EMULSION.
- ALL NEW PAVEMENT SHALL BE GRADED SO THAT NO PONDING FORMS. THE MINIMUM CROSS SLOPE ON ANY NEW OR OVERLAIN ROAD SURFACE SHALL BE 2%.
- ALL VALVES BOXES, MANHOLES, ETC., THAT ARE WITHIN THE PAVED SURFACE SHALL BE ADJUSTED TO FINISHED COURSE ELEVATION PRIOR TO FINISH COURSE PAVING.
- ALL PAVING TO BE IN ACCORDANCE WITH MMCD SECTION 32 12 16 - HOT-MIX ASPHALT CONCRETE PAVING, MIX DESIGN TO BE APPROVED BY GEOTECHNICAL ENGINEER.
- ALL DISTURBED AREAS, INCLUSIVE OF THE MSE WALL SHALL BE TOP SOILED AND SEEDED IN ACCORDANCE WITH MMCD SECTION 32 92 20 - SEEDING.
- ANY LOCATION WHERE THE ADJACENT SURFACE IS GREATER THAN OR EQUAL TO 600mm IN HEIGHT, OR A SLOPE GREATER THAN 2H:1V REQUIRES A GUARDRAIL.
- GUARDRAILS SHALL BE CONSTRUCTED IN ACCORDANCE WITH MMCD STANDARD DETAIL C14, ANCHORED IN EARTH PER STANDARD DETAIL C13.
- PATH SHALL BE CROSS SLOPED AT 2% TOWARDS LOCAL DRAINAGE, AS PER CONTACT DRAWINGS.

ENVIRONMENTAL AND TREE PROTECTION:

- CONTRACTOR TO OBTAIN PERMISSION FROM THE TOWN OF SIDNEY PRIOR TO REMOVAL OF ANY TREES ON PRIVATE OR PUBLIC PROPERTY. TREES AND TREE ROOTS ARE TO BE PROTECTED DURING CONSTRUCTION. HAND DIG WHERE ROOTS OVER 50MM ARE ENCOUNTERED. TOWN OF SIDNEY ARBORIST TO BE CONTACTED BY THE CONTRACTOR.
- ALL WORK TO BE UNDERTAKEN USING UP TO DATE EROSION AND SEDIMENT CONTROL BEST MANAGEMENT PRACTICES TO PREVENT THE RELEASE OF SEDIMENT LADEN WATER INTO THE STREET, AND ANY STORM SYSTEM STRUCTURE.
- CONTRACTOR IS RESPONSIBLE FOR ALL ENVIRONMENTAL PROTECTION PROCEDURES FOR HANDLING AND STORAGE OF ALL HAZARDOUS MATERIALS INCLUDING OIL, GREASE, AND FUELS. ANY SPILL SHALL BE REPORTED TO THE BC PROVINCIAL EMERGENCY PROGRAM (1-800-663-3456). SPILL CLEAN-UP IS THE RESPONSIBILITY OF THE CONTRACTOR AND SHALL BE DONE IMMEDIATELY AT THE SPILL SITE AND TO ALL AFFECTED SURROUNDING AREAS.
- RETAIN EXISTING VEGETATION AND GROUND COVER WHERE POSSIBLE.

PROJECT LEGEND	PROPOSED
STORM CULVERT	---
RETAINING WALL	---
STREET LIGHT	●
GRAVEL SHOULDER	---
PROPOSED PAVED MULTI USE PATH	---



EXISTING		LEGEND		PROPOSED	
—	SANITARY SEWER	—	S	—	SANITARY SEWER
—	STORM DRAIN WATER	—	D	—	STORM DRAIN
—	MAIN	—	W	—	WATER MARK
—	GAS LINE	—	G	—	GAS LINE
—	EDGE OF PAVEMENT	—	—	—	EDGE OF PAVEMENT
—	FACE OF CURB	—	—	—	FACE OF CURB
—	PROPERTY LINES	—	—	—	PROPERTY LINES
—		—	—	—	MANHOLE
—		—	—	—	CATCH BASIN
—		—	—	—	HYDROTEL POLE
—		—	—	—	WATER METER
—		—	—	—	WATER VALVE
—		—	—	—	FIRE HYDRANT

CYCLE PATH REPLACEMENT HIGHWAY 17 NOTES
FROM McDONALD PARK ROAD TO MALAVIEW AVE WEST

REVISIONS			
NO.	REVISION DESCRIPTION	DATE	INITIALS
4			
3			
2			
1	ISSUED FOR TENDER	JAN 23, 2023	SG NC



TOWN OF SIDNEY		FIELD BOOK	FB #
B.M. 78H7245	ELEV. 10.663m		
DESIGN: NC	DRAWN: SG	APPROVED: NC	SHEET 2 of 7
SCALES Hor. 1:250	Vert. 1:50	DATE: JAN 2023	FILE DWG. No. 001

ISSUED FOR TENDER

EGBC PERMIT TO PRACTICE NO.: 1002678

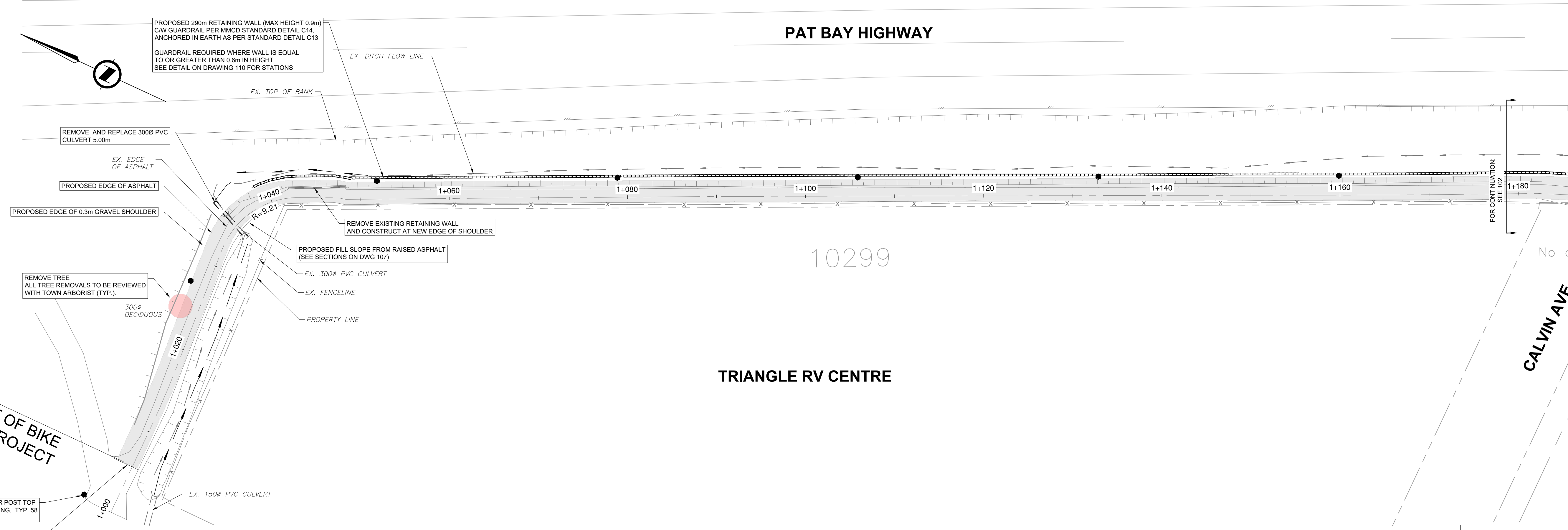
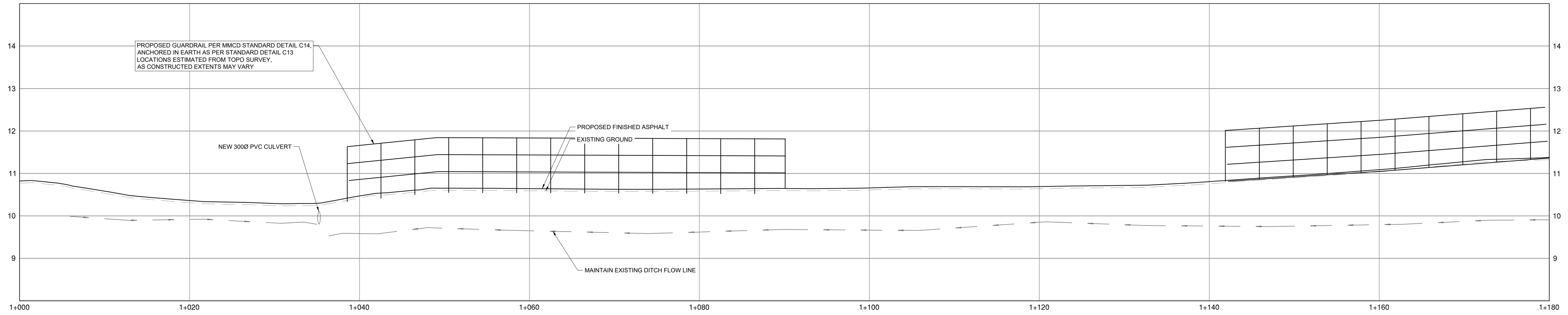

SURVEY MONUMENTS LOCATION	REFERENCE	ELEVATION
N END OF PATH AT McDONALD PARK RD	78H7245	10.663m
MALAVIEW AVE WEST	79H0530	12.255m
MILLS ROAD WEST	79H0519	12.687m
HENRY AVE WEST AT McDONALD PARK RD.	79H0501	12.262m

EGBC PERMIT TO PRACTICE NO.: 1002678

PROJECT LEGEND	PROPOSED
STORM CULVERT	
RETAINING WALL	
STREET LIGHT	
GRAVEL SHOULDER	
PROPOSED PAVED MULTI USE PATH	

NOTICE
 BC T-CALL MUST BE COMPLETED FOR THE AREA SHOWN ON THIS DRAWING PRIOR TO ANY EXCAVATION. THIS PROCESS MUST BE REPEATED AT LEAST 72 HOURS PRIOR TO CONSTRUCTION.

NOTICE
 AN UNDERGROUND UTILITY SEARCH INCLUDING BC T-CALL HAS BEEN COMPLETED FOR DESIGN PURPOSES FOR THE AREA SHOWN ON THIS DRAWING. IF ANY EXCAVATION IS TO BE DONE WITHIN OR OUTSIDE THE DRAWING LIMITS, THIS PROCESS MUST BE REPEATED AT LEAST 72 HOURS PRIOR TO CONSTRUCTION.
 TICKET # 20211005833

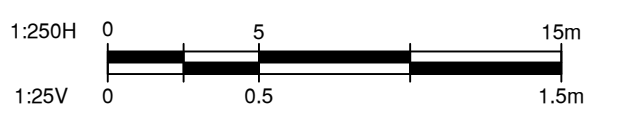

EXISTING	LEGEND	PROPOSED
	MANHOLE	
	CATCH BASIN	
	HYDRO/TEL POLE	
	WATER MARK	
	WATER METER	
	WATER VALVE	
	FIRE HYDRANT	

CYCLE PATH REPLACEMENT HIGHWAY 17

PLAN AND PROFILE FROM McDONALD PARK ROAD TO MALAVIEW AVE WEST

REVISIONS			
4			
3			
2			
1	ISSUED FOR TENDER	JAN 23, 2023	SG NC
	REVISION DESCRIPTION	DATE	INITIALS APPR.

TOWN OF SIDNEY		FIELD BOOK	FB #
B.M. 78H7245	ELEV. 10.663m		
DESIGN: NC	DRAWN: SG	SHEET DWG. No.	3 of 7
APPROVED: NC	DATE: JAN 2023	FILE DWG. No.	101

ISSUED FOR TENDER

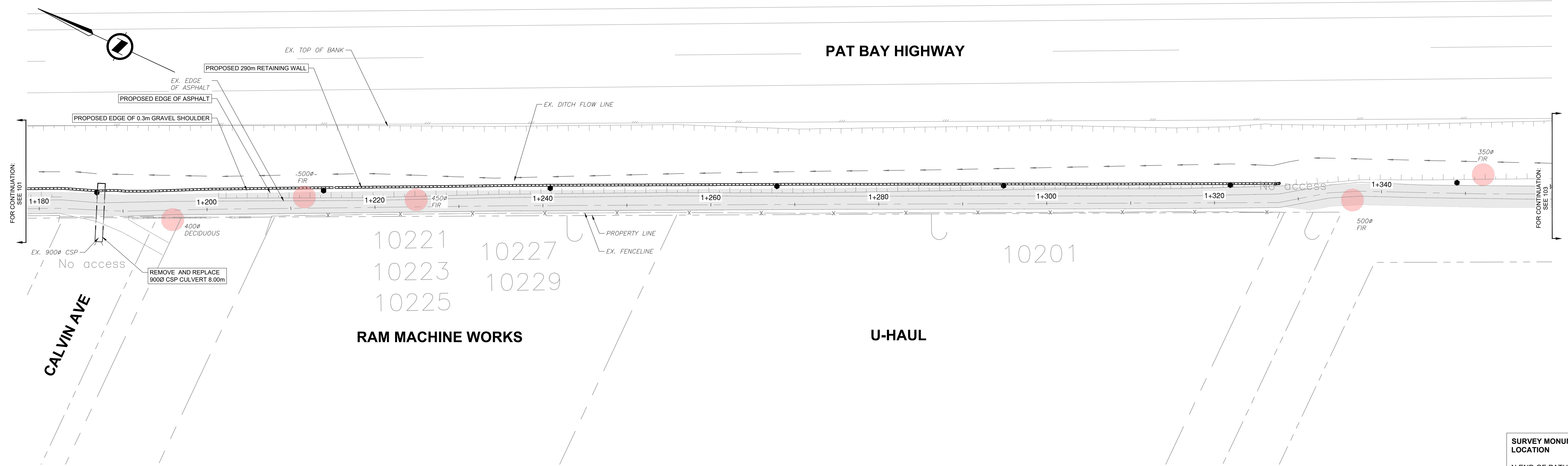
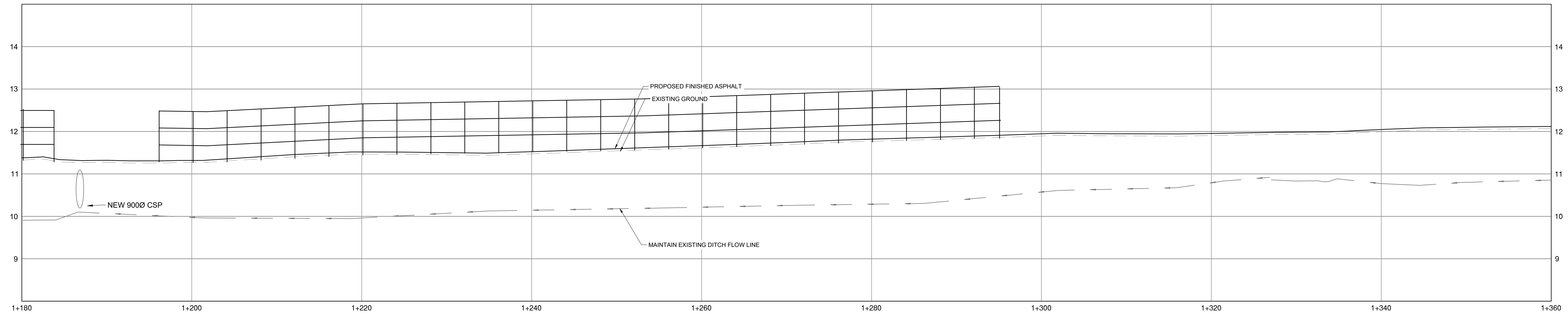

NOTICE
 BC ICALL MUST BE COMPLETED FOR THE AREA SHOWN ON THIS DRAWING PRIOR TO ANY EXCAVATION. THIS PROCESS MUST BE REPEATED AT LEAST 72 HOURS PRIOR TO CONSTRUCTION.

NOTICE
 AN UNDERGROUND UTILITY SEARCH INCLUDING BC ICALL HAS BEEN COMPLETED FOR DESIGN PURPOSES FOR THE AREA SHOWN ON THIS DRAWING. IF ANY EXCAVATION IS TO BE DONE WITHIN OR OUTSIDE THE DRAWING LIMITS, THIS PROCESS MUST BE REPEATED AT LEAST 72 HOURS PRIOR TO CONSTRUCTION.
 TICKET # 20211005833

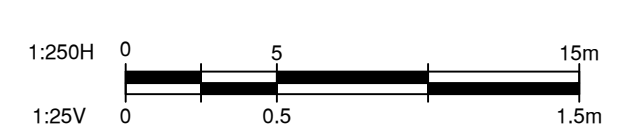

PROJECT LEGEND	PROPOSED
STORM CULVERT	
RETAINING WALL	
STREET LIGHT	
GRAVEL SHOULDER	
PROPOSED PAVED MULTI USE PATH	

SURVEY MONUMENTS LOCATION	REFERENCE	ELEVATION
N END OF PATH AT McDONALD PARK RD	78H7245	10.663m
MALVIEW AVE WEST	79H0530	12.255m
MILLS ROAD WEST	79H0519	12.687m
HENRY AVE WEST AT McDONALD PARK RD.	79H0501	12.262m

EGBC PERMIT TO PRACTICE NO.: 1002678

LEGEND	
EXISTING	PROPOSED
SANITARY SEWER	SANITARY SEWER
STORM DRAIN WATER	STORM DRAIN
MAIN	WATER MARK
GAS LINE	WATER METER
EDGE OF PAVEMENT	WATER VALVE
FACE OF CURB	FIRE HYDRANT
PROPERTY LINES	MANHOLE
	CATCH BASIN
	HYDROTEL POLE
	WATER METER
	WATER VALVE
	FIRE HYDRANT

CYCLE PATH REPLACEMENT HIGHWAY 17

PLAN AND PROFILE FROM McDONALD PARK RD TO MALVIEW AVE WEST

REVISIONS			
NO.	REVISION DESCRIPTION	DATE	INITIALS
1	ISSUED FOR TENDER	JAN 23, 2023	SG NC
2			
3			
4			

TOWN OF SIDNEY		FIELD BOOK	FB #
B.M. 78H7245	ELEV. 10.663m		4 of 7
DESIGN: NC	DRAWN: SG	APPROVED: NC	SHEET DWG. No.
SCALES: Hor. 1:250	Vert. 1:50	DATE: JAN 2023	FILE DWG. No.

ISSUED FOR TENDER

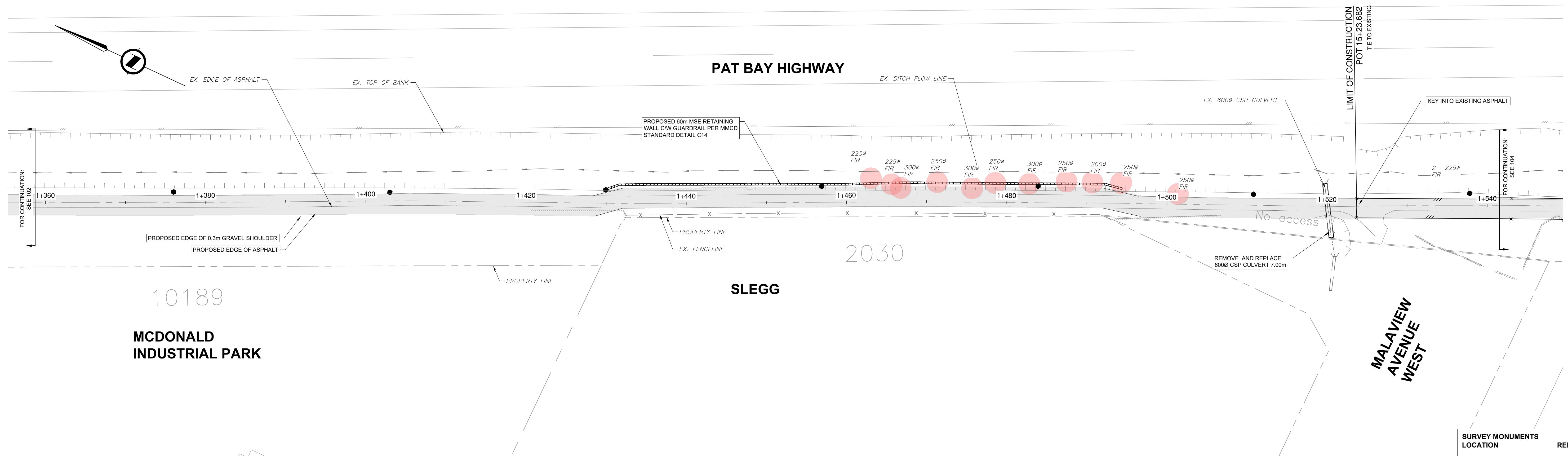
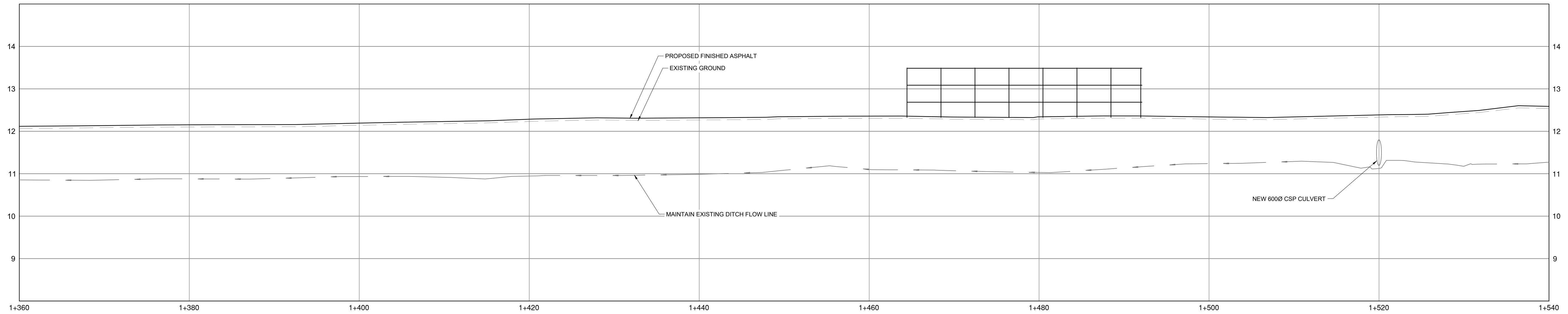

NOTICE
 BC ICALL MUST BE COMPLETED FOR THE AREA SHOWN ON THIS DRAWING PRIOR TO ANY EXCAVATION. THIS PROCESS MUST BE REPEATED AT LEAST 72 HOURS PRIOR TO CONSTRUCTION.

NOTICE
 AN UNDERGROUND UTILITY SEARCH INCLUDING BC ICALL HAS BEEN COMPLETED FOR DESIGN PURPOSES FOR THE AREA SHOWN ON THIS DRAWING. IF ANY EXCAVATION IS TO BE DONE WITHIN OR OUTSIDE THE DRAWING LIMITS, THIS PROCESS MUST BE REPEATED AT LEAST 72 HOURS PRIOR TO CONSTRUCTION.
 TICKET # 20211005833

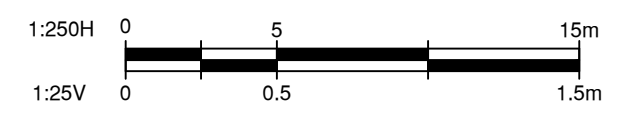

PROJECT LEGEND		PROPOSED	
STORM CULVERT		RETAINING WALL	
RETAINING WALL		STREET LIGHT	
STREET LIGHT		GRAVEL SHOULDER	
GRAVEL SHOULDER		PROPOSED PAVED MULTI USE PATH	
PROPOSED PAVED MULTI USE PATH			

SURVEY MONUMENTS LOCATION	REFERENCE	ELEVATION
N END OF PATH AT McDONALD PARK RD	78H7245	10.663m
MALAVIEW AVE WEST	79H0530	12.255m
MILLS ROAD WEST	79H0519	12.687m
HENRY AVE WEST AT McDONALD PARK RD.	79H0501	12.262m

EGBC PERMIT TO PRACTICE NO.: 1002678

EXISTING		PROPOSED	
	SANITARY SEWER		SANITARY SEWER
	STORM DRAIN WATER		STORM DRAIN
	MANHOLE		MANHOLE
	CATCH BASIN		CATCH BASIN
	HYDROTEL POLE		HYDROTEL POLE
	WATER METER		WATER METER
	WATER VALVE		WATER VALVE
	FIRE HYDRANT		FIRE HYDRANT
	EDGE OF PAVEMENT		EDGE OF PAVEMENT
	FACE OF CURB		FACE OF CURB
	PROPERTY LINES		PROPERTY LINES

CYCLE PATH REPLACEMENT HIGHWAY 17

PLAN AND PROFILE FROM McDONALD PARK ROAD TO MALAVIEW AVE WEST

REVISIONS			
NO.	REVISION DESCRIPTION	DATE	INITIALS
1	ISSUED FOR TENDER	JAN 23, 2023	SG NC
2			
3			
4			



TOWN OF SIDNEY		FIELD BOOK	FB #
B.M. 79H0519	ELEV. 12.687m		
DESIGN: NC	DRAWN: SG	SHEET DWG. No.	5 of 7
APPROVED: NC	DATE: JAN 2023	FILE DWG. No.	103
SCALES: Hor. 1:250	Vert. 1:50		

ISSUED FOR TENDER

LEGEND:
 EP - EDGE OF EXISTING ASPHALT PAVING
 FE - EXISTING FENCELINE
 RW - EXISTING RETAINING WALL

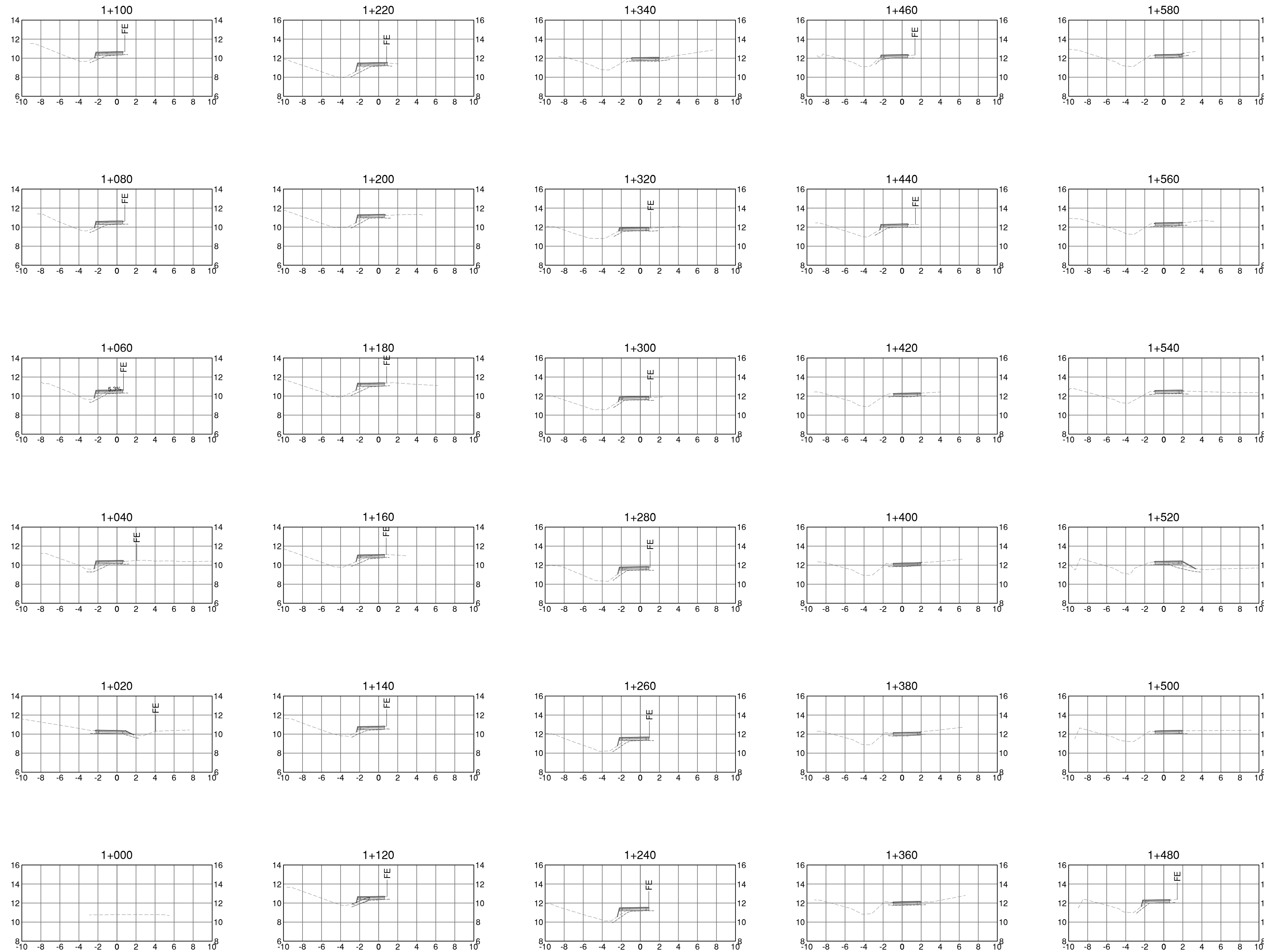

NOTICE
 BC ICALL MUST BE COMPLETED FOR THE AREA SHOWN ON THIS DRAWING PRIOR TO ANY EXCAVATION. THIS PROCESS MUST BE REPEATED AT LEAST 72 HOURS PRIOR TO CONSTRUCTION.



NOTICE
 AN UNDERGROUND UTILITY SEARCH INCLUDING BC ICALL HAS BEEN COMPLETED FOR DESIGN PURPOSES FOR THE AREA SHOWN ON THIS DRAWING. IF ANY EXCAVATION IS TO BE DONE WITHIN OR OUTSIDE THE DRAWING LIMITS, THIS PROCESS MUST BE REPEATED AT LEAST 72 HOURS PRIOR TO CONSTRUCTION.
 TICKET # 20211005833

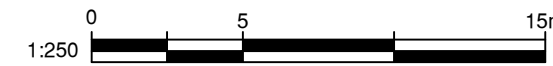

PROFESSIONAL ENGINEER
 J. A. MALLISTER
 # 30593

EGBC PERMIT TO PRACTICE NO.: 1002678

EXISTING		PROPOSED	
	SANITARY SEWER		SANITARY SEWER
	STORM DRAIN		STORM DRAIN
	MANHOLE		MANHOLE
	CATCH BASIN		CATCH BASIN
	HYDRO-TEL POLE		HYDRO-TEL POLE
	WATER METER		WATER METER
	WATER VALVE		WATER VALVE
	FIRE HYDRANT		FIRE HYDRANT
	EDGE OF PAVEMENT		EDGE OF PAVEMENT
	FACE OF CURB		FACE OF CURB
	PROPERTY LINES		PROPERTY LINES

CYCLE PATH REPLACEMENT HIGHWAY 17

SECTION 1 FROM McDONALD PARK ROAD TO MALAVIEW AVE WEST

REVISIONS			
NO.	REVISION DESCRIPTION	DATE	INITIALS
4			
3			
2			
1	ISSUED FOR TENDER	JAN 23, 2023	SG NC



TOWN OF SIDNEY			FIELD BOOK	FB #
B.M. MON#	ELEV. _m	DESIGN: NC	DRAWN: SG	APPROVED: NC
DESIGN: NC	DRAWN: SG	APPROVED: NC	DATE: JAN 2023	
SCALES Hor: 1:250	Vert: 1:50			

ISSUED FOR TENDER

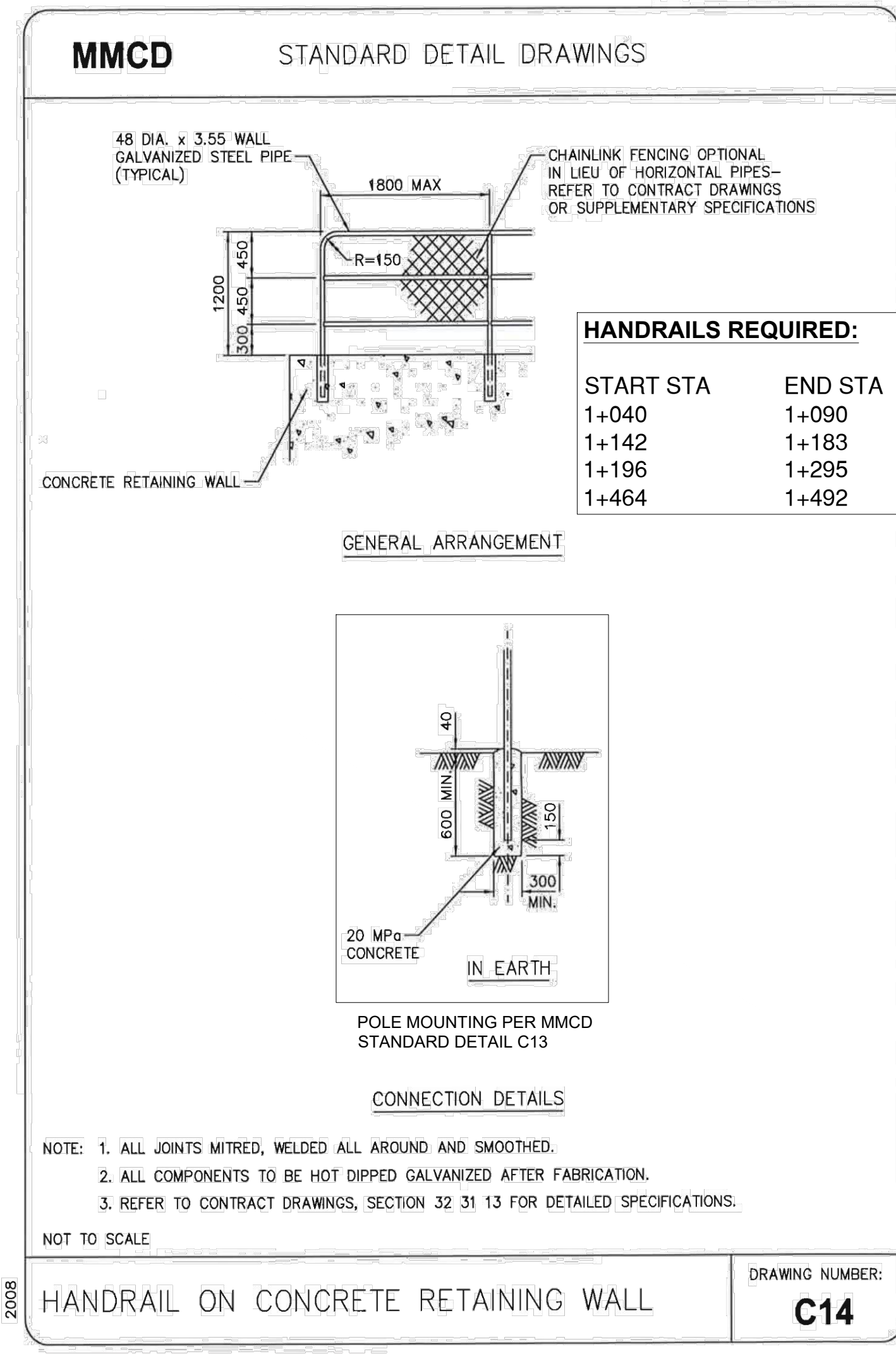
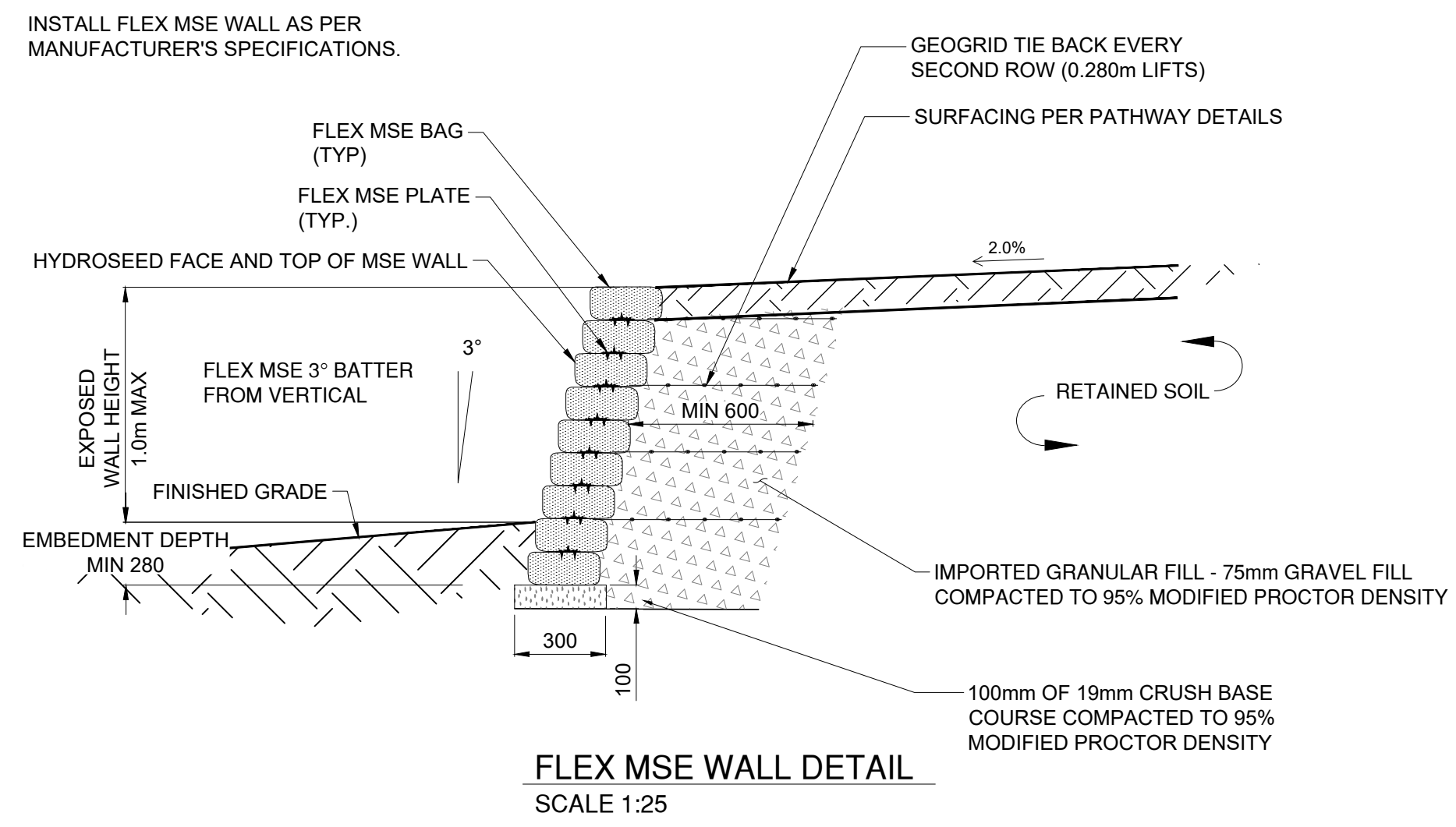
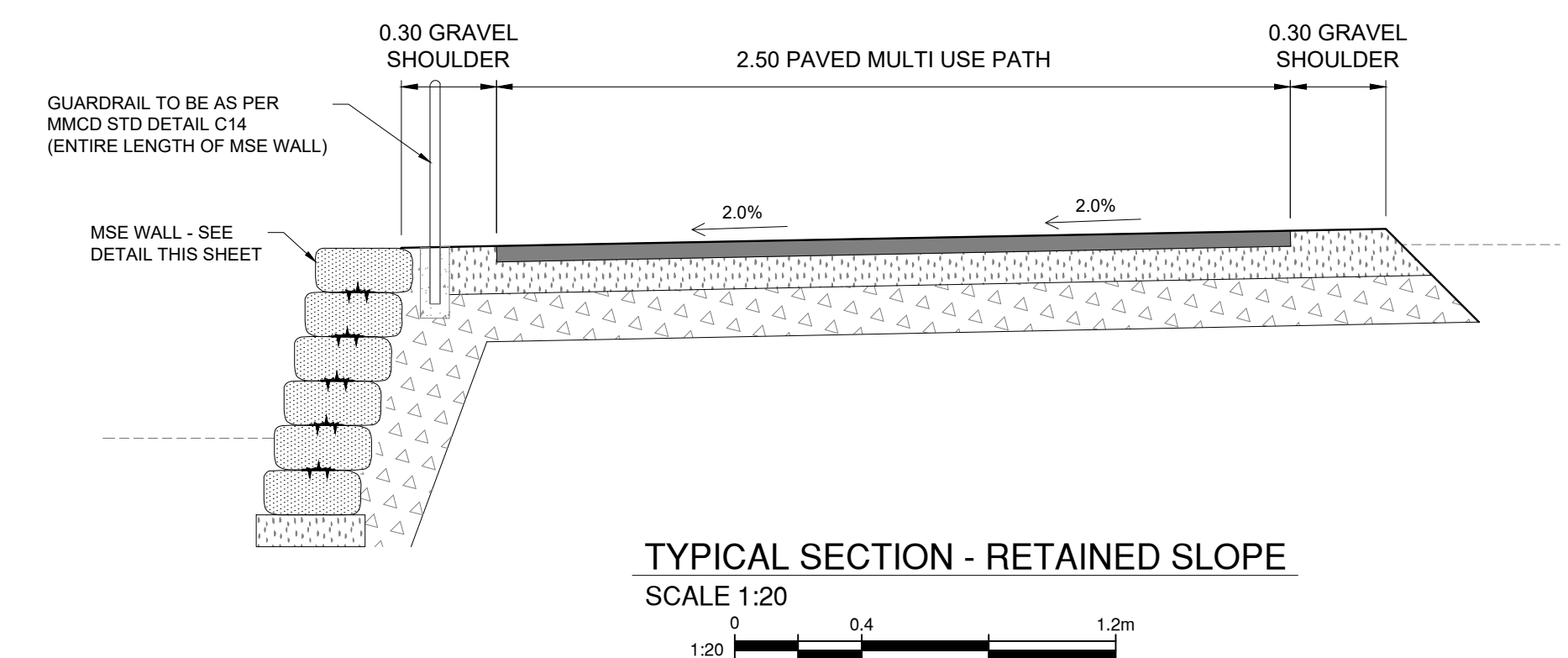
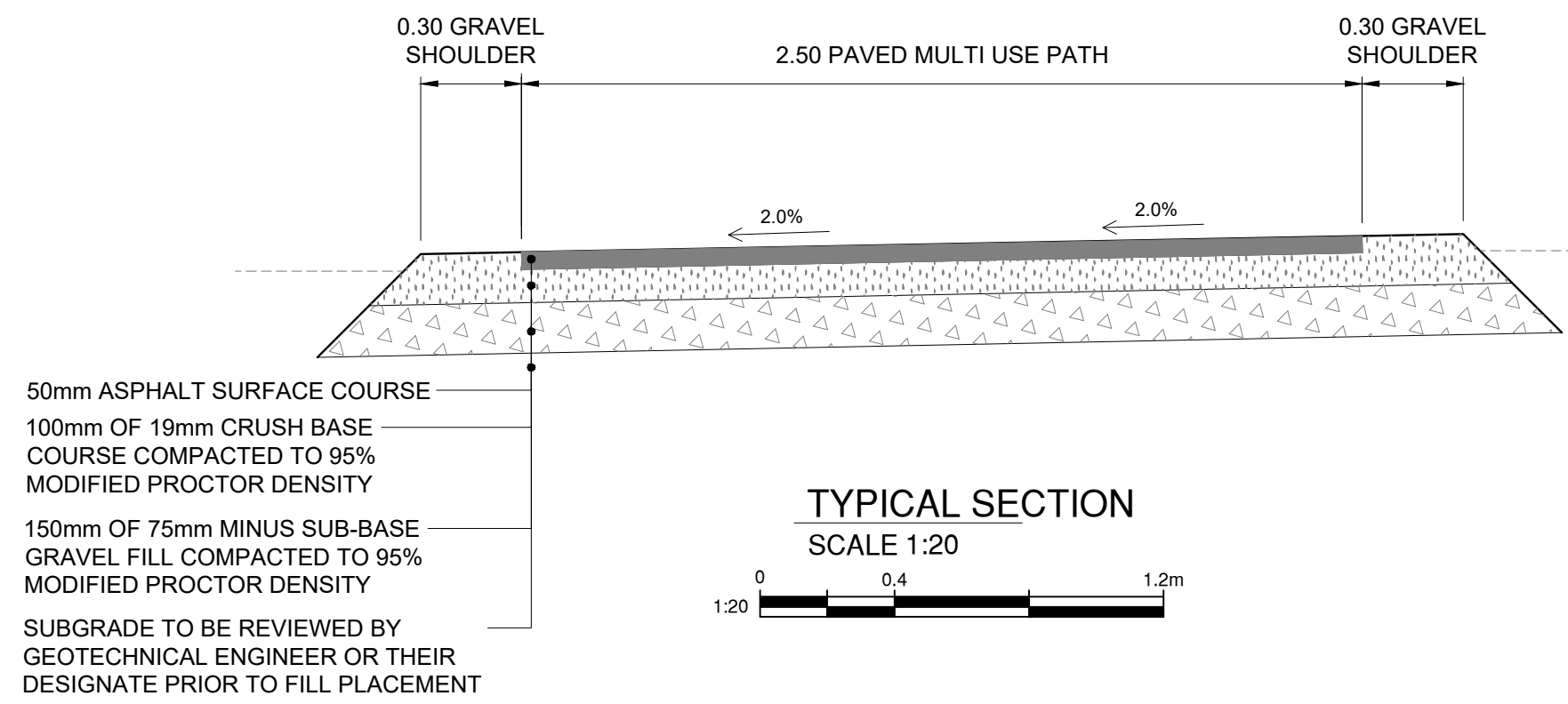

MMCD - Platinum Edition Volume II Copyright Master Municipal Construction Documents Association (c) 2009

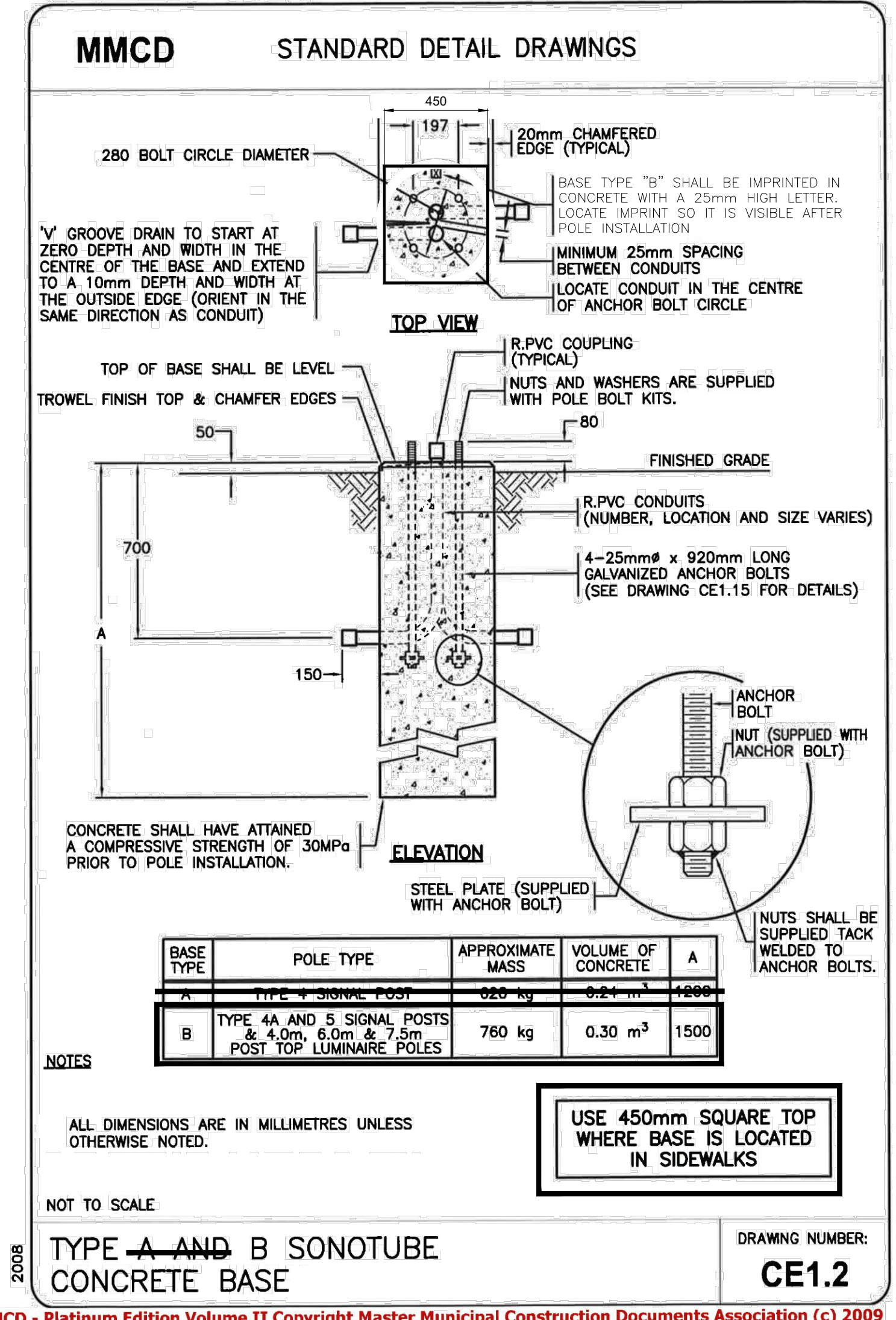

MMCD - Platinum Edition Volume II Copyright Master Municipal Construction Documents Association (c) 2009

NOTICE
BIC CALL MUST BE COMPLETED FOR THE AREA SHOWN ON THIS DRAWING PRIOR TO ANY EXCAVATION. THIS PROCESS MUST BE REPEATED AT LEAST 72 HOURS PRIOR TO CONSTRUCTION.

NOTICE
AN UNDERGROUND UTILITY SEARCH INCLUDING BIC CALL HAS BEEN COMPLETED FOR DESIGN PURPOSES FOR THE AREA SHOWN ON THIS DRAWING. IF ANY EXCAVATION IS TO BE DONE WITHIN OR OUTSIDE THE DRAWING LIMITS, THIS PROCESS MUST BE REPEATED AT LEAST 72 HOURS PRIOR TO CONSTRUCTION.
TICKET # 20211005833

PROFESSIONAL ENGINEER
J.A. McALLISTER
30593

LEGEND

EXISTING	PROPOSED
— S — SANITARY SEWER	— S — SANITARY SEWER
— SD — STORM DRAIN WATER	— SD — STORM DRAIN
— M — MAIN	— W — WATER MAIN
— G — GAS LINE	— W — WATER METER
— E — EDGE OF PAVEMENT	— W — WATER VALVE
— F — FACE OF CURB	— W — FIRE HYDRANT
— P — PROPERTY LINES	
— M — MANHOLE	— M — MANHOLE
— C — CATCH BASIN	— C — CATCH BASIN
— H — HYDROTEL POLE	— H — HYDROTEL POLE
— W — WATER METER	— W — WATER METER
— V — WATER VALVE	— V — WATER VALVE
— F — FIRE HYDRANT	— F — FIRE HYDRANT

CYCLE PATH REPLACEMENT HIGHWAY 17
TYPICAL DETAILS FROM McDONALD PARK ROAD TO MALAVIEW AVE WEST

REVISIONS

NO.	REVISION DESCRIPTION	DATE	INITIALS	APPR.
4				
3				
2				
1	ISSUED FOR TENDER	JAN 23, 2023	SG	NC

TOWN OF SIDNEY

DESIGN: NC	DRAWN: SG	ELEV. _m	APPROVED: NC
SCALES Hor. 1:250	Vert. 1:50	DATE: JAN 2023	

FIELD BOOK	FB #
	7 of 7

FILE	DWG. No.
	110

ISSUED FOR TENDER

EGBC PERMIT TO PRACTICE NO.: 1002678