

THIS DRAWING IS FOR THE SOLE USE OF THE CLIENT AND NO REPRESENTATIONS OF ANY KIND ARE MADE TO ANY OTHER PARTY.

FILE NO.: C:\Users\carol.davies\WSP-0365\CA0010231\6061 CA-Town of Sidney - Pump Station Review - 05\_Technical\Civil DWG\Production\CA0010231 6061-FigureHPS - 8/17/2025 6:47:35 PM

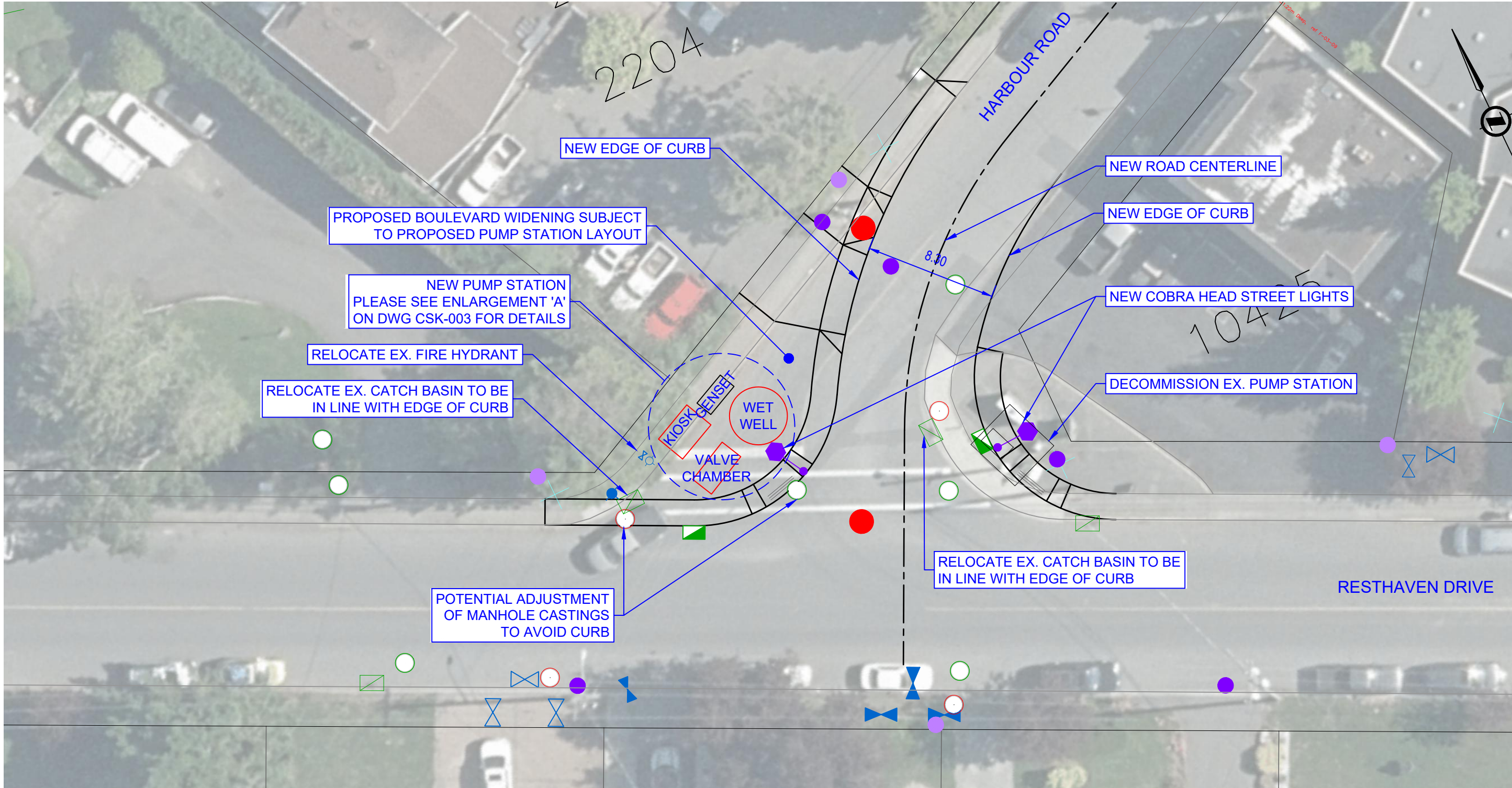

	SEWER
	STORM
	WATER
	GAS
	POWER
	TEL
	CABLE

REVISIONS					
4					
3					
2					
1					
REVISION DESCRIPTION		DATE	INITIALS	APPR.	



TOWN OF SIDNEY		
HARBOUR PUMP STATION REPLACEMENT SURFACE WORKS		
B.M. zzz		ELEV. _m
DESIGN: LB	DRAWN: cld	APPROVED: _
SCALES Hor. 1:250	Vert.	DATE: JULY 2025

FIELD BOOK	NA
SHEET DWG. No.	1 of 3
FILE DWG. No.	CSK-001

ISSUED FOR REVIEW







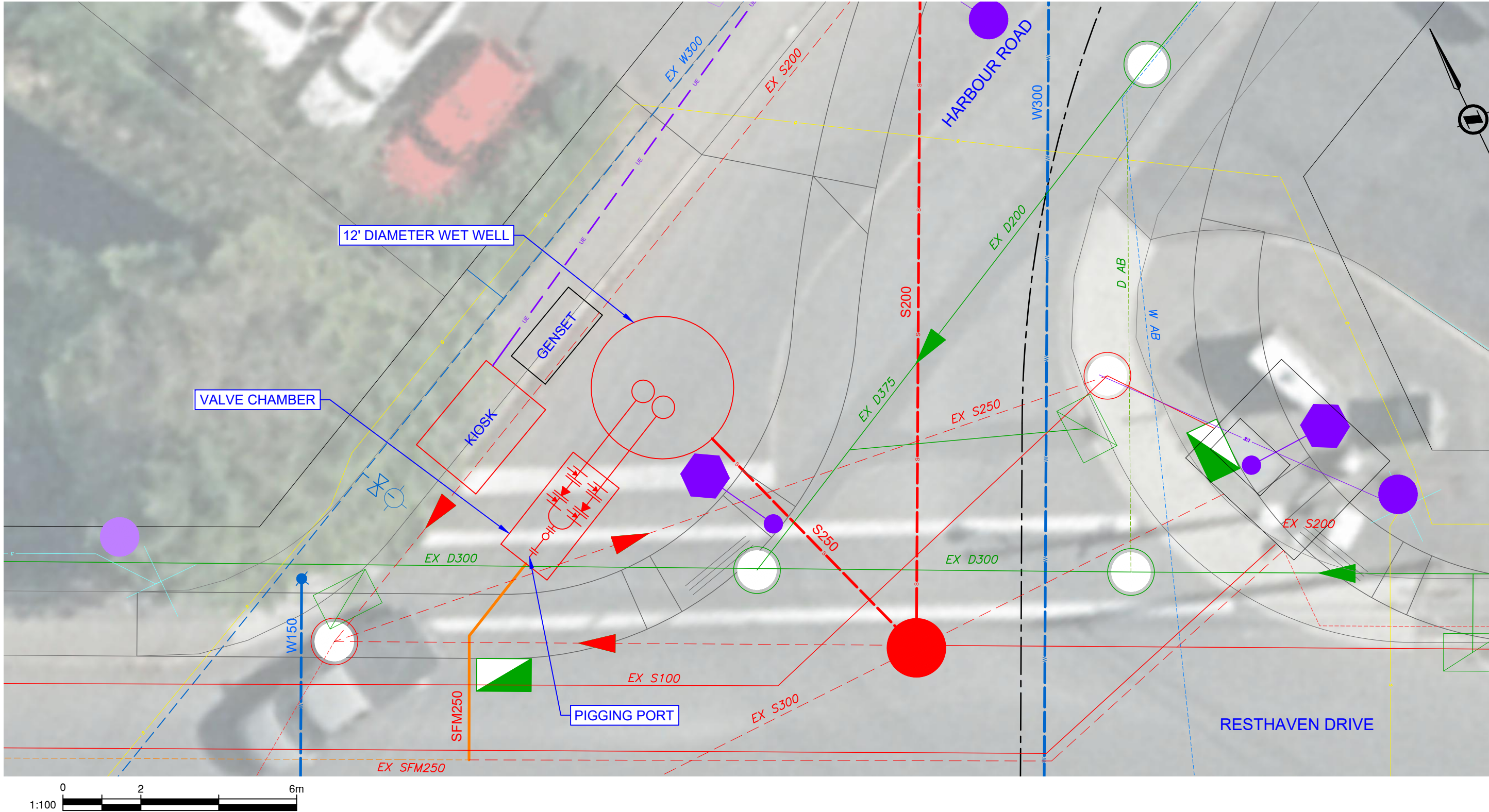

 SEWER STORM WATER GAS POWER TEL CABLE	REVISIONS						TOWN OF SIDNEY			FIELD BOOK	NA
	4						HARBOUR PUMP STATION REPLACEMENT				
	3						UNDERGROUND WORKS			SHEET DWG. No.	2 of 3
	2						B.M. zzz		ELEV. _m		
	1						DESIGN: LB	DRAWN: cld	APPROVED: _	FILE DWG. No.	CSK-002
		REVISION DESCRIPTION		DATE	INITIALS		APPR.	SCALES Hor. 1:250 Vert.			

FILE NO.: C:\Users\carol.davies\WSP-0365\CA0010231\6061 CA-Town of Sidney - Pump Station Replacement - 05\_Technical\City\9 DWG\Production\CA0010231\_6061-FigureHPS 8/07/2025 6:47:49 PM THIS DRAWING IS FOR THE SOLE USE OF THE CLIENT AND NO REPRESENTATIONS OF ANY KIND ARE MADE TO ANY OTHER PARTY.



ISSUED FOR REVIEW

	SEWER
	STORM
	WATER
	GAS
	POWER
	TEL
	CABLE

REVISIONS					
4					
3					
2					
1					
REVISION DESCRIPTION		DATE	INITIALS	APPR.	



TOWN OF SIDNEY		
HARBOUR PUMP STATION REPLACEMENT SITE		
B.M. zzz		ELEV. _m
DESIGN: LB	DRAWN: cld	APPROVED: _
SCALES Hor. 1:250	Vert.	DATE: JULY 2025

FIELD BOOK	NA
SHEET DWG. No.	3 of 3
FILE DWG. No.	CSK-003

THIS DRAWING IS FOR THE SOLE USE OF THE CLIENT AND NO REPRESENTATIONS OF ANY KIND ARE MADE TO ANY OTHER PARTY.

FILE NO.: C:\Users\carol.davies\WSP-0365\CA0010231\6061 CA-Town of Sidney - Pump Station Replacement - 05\_Technical\Civil\DWG\Production\CA0010231\6061-FigureHPS-80702025-6-47-54 PM

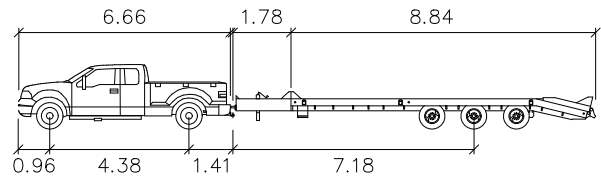

Big Tex 5XPH-24+5 Heavy Hitch

	meters
Car Width	: 2.03
Trailer Width	: 2.59
Car Track	: 2.41
Trailer Track	: 2.59
Lock to Lock Time	: 6.0
Steering Angle	: 34.2
Articulating Angle	: 70.0

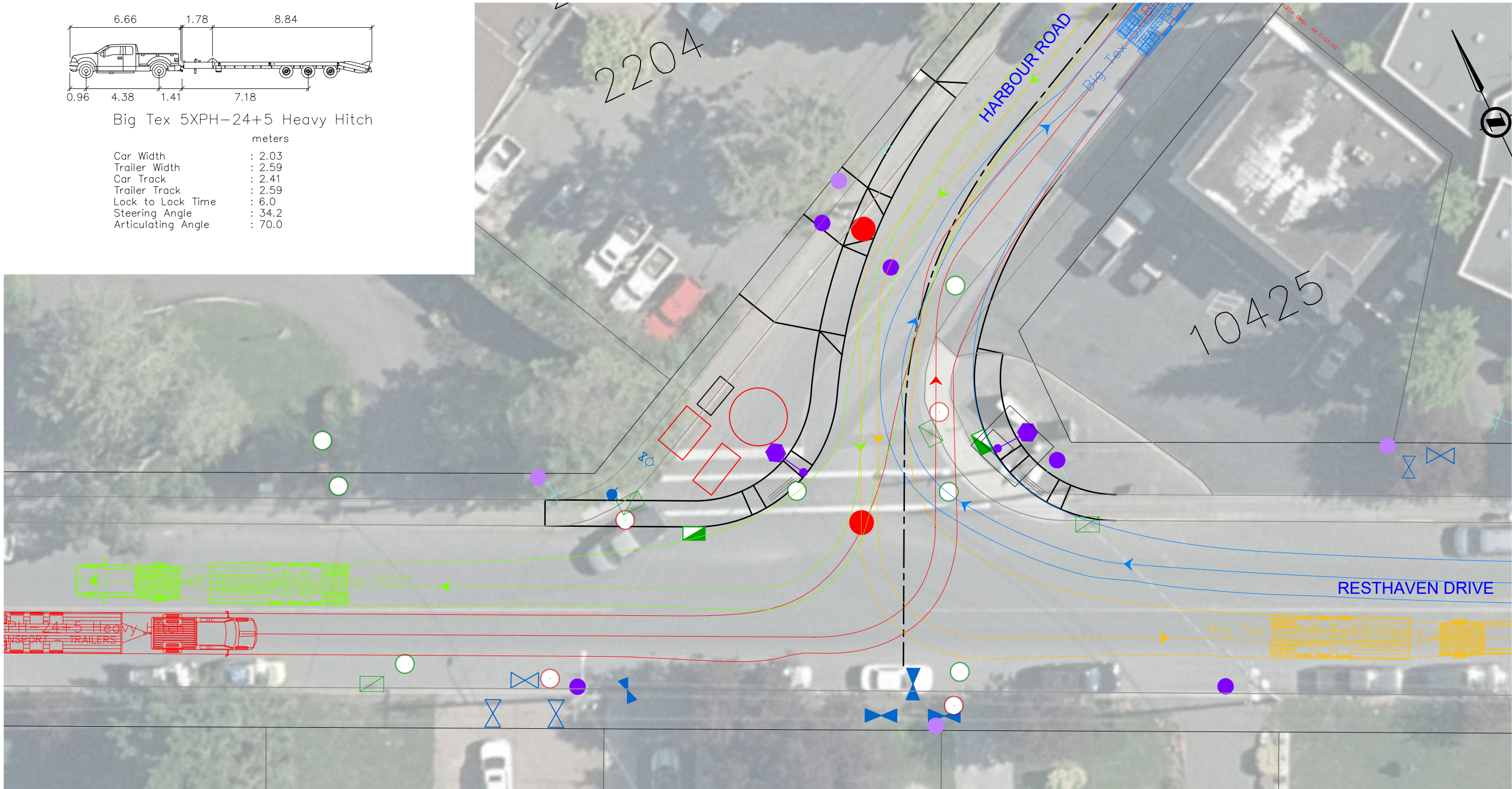

	SEWER
	STORM
	WATER
	GAS
	POWER
	TEL
	CABLE

REVISIONS					
4					
3					
2					
1					
REVISION DESCRIPTION		DATE	INITIALS	APPR.	



TOWN OF SIDNEY		
HARBOUR PUMP STATION REPLACEMENT		
VEHICLE TRACKING		
B.M. zzz		ELEV. _m
DESIGN: LB	DRAWN: cld	APPROVED: _
SCALES Hor. 1:250	Vert.	DATE: JULY 2025

FIELD BOOK	NA
SHEET DWG. No.	1 of 1
FILE DWG. No.	CSK-00X

ISSUED FOR REVIEW